

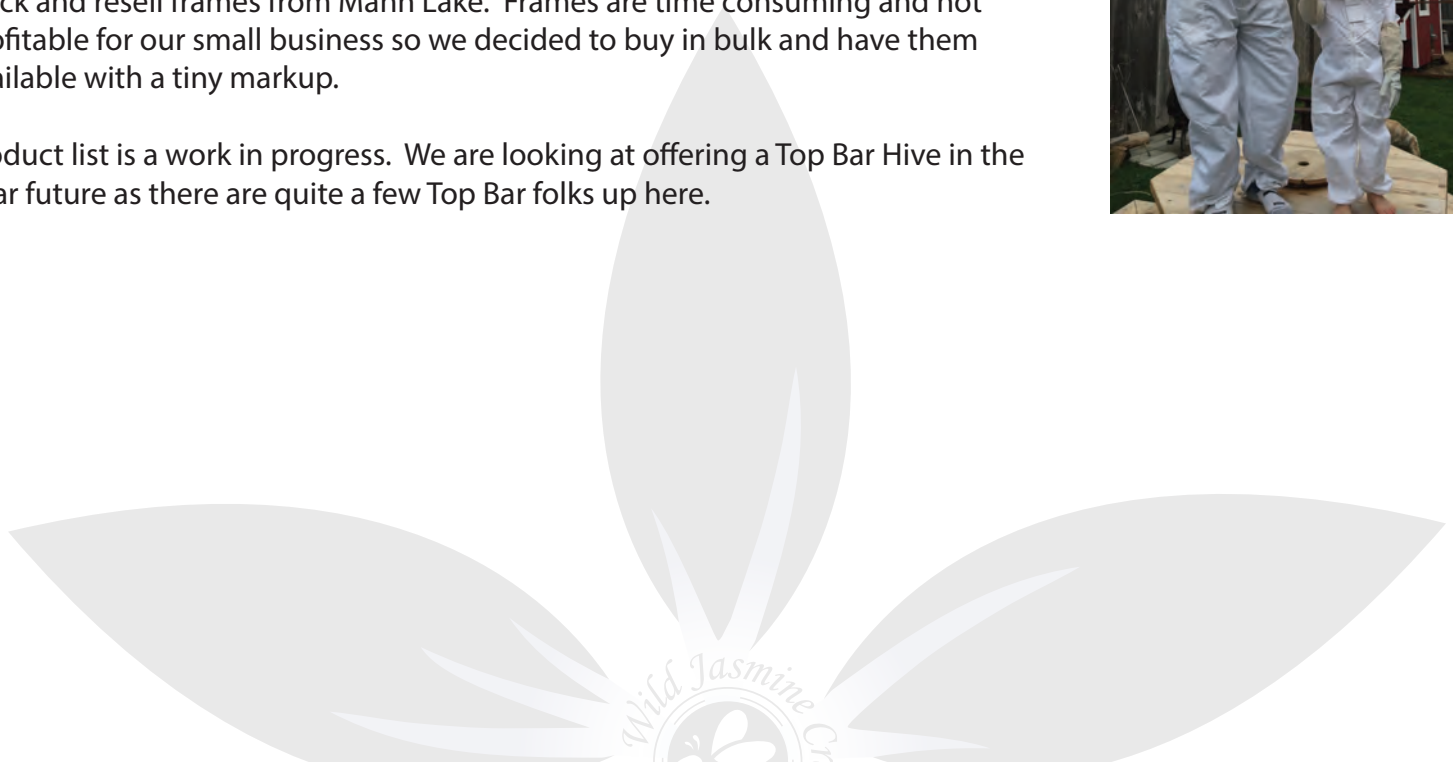

Price List

Thanks for taking a look at our bee gear. Here is our product list. For frames we stock and resell frames from Mann Lake. Frames are time consuming and not profitable for our small business so we decided to buy in bulk and have them available with a tiny markup.

Product list is a work in progress. We are looking at offering a Top Bar Hive in the near future as there are quite a few Top Bar folks up here.



We also sell honey (like every other beekeeper) for \$15 per pound



If you have picked up gear at my shop, I'm sure you have met Butters. Master of the photo-bomb.



BOTTOM BOARDS (assembled)

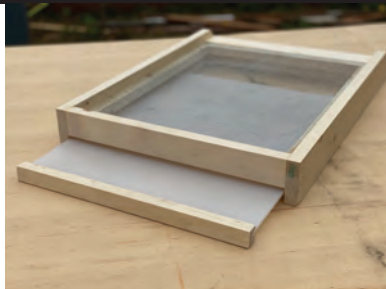

Langstroth screened bottom boards with IPM slider; 10 frame, 8 frame and 5 frame nucs. Each bottom board comes with a reducer.

10 Frame - \$50 ea

8 Frame - \$50 ea

5 Frame Nuc - \$30 ea



Wood in image is recycled cedar. We love to repurpose wood when possible. We mostly use pine but love using other soft woods when available.

Langstroth solid bottom boards; 10 frame, 8 frame and 5 frame nucs. Each bottom board comes with a reducer.

10 Frame - \$40 ea

8 Frame - \$40 ea

5 Frame Nuc - \$20 ea

INNER COVERS (assembled)



Inner Cover; 10 frame, 8 frame and 5 frame nucs. Our inner covers have the 3/4" spacer built into one side.

10 Frame - \$30 ea

8 Frame - \$30 ea

5 Frame Nuc - \$25 ea



LIDS (assembled)



Langstroth Telescoping Lids; 10 frame, 8 frame and 5 frame nucs.

10 Frame - \$45 ea

8 Frame - \$45 ea

5 Frame Nuc - \$30 ea



Langstroth Migratory Lids; 10 frame, 8 frame and 5 frame nucs. No plywood. Made of T&G pine.

10 Frame - \$20 ea

8 Frame - \$20 ea

5 Frame Nuc - \$15 ea

BROOD BODIES & SUPERS (assembled)



Langstroth Deeps;
10 frame and 8 frame

10 frame Deep - \$45 ea
8 frame Deep - \$45 ea

Langstroth Mediums;
10 frame and 8 frame

10 frame Deep - \$35 ea
8 frame Deep - \$35 ea

*Langstroth Nucs

5 frame Deep Nuc- \$35 ea
5 frame Med Nuc - \$25 ea

FONDATION & FRAMES (unassembled)



Mann Lake Frames; Unassembled - Wedged top and slotted bottoms. End bars have holes. Use with pure beeswax foundation.

FR-922 • 9 1/8" Frame (Use with 9 5/8" bodies and 8 1/2" foundation)
\$2.50 ea

FR-932 • 6 1/4" Frame (Use with 6 5/8" supers and 5 5/8" foundation)
\$2.50 ea

Pure Beeswax Foundation

FN-261 • 8 3/8" x 16 3/4" wired foundation with hooks (for deep frames)
\$2.00 ea

FN-237 • 5 5/8" x 16 3/4" wired foundation with hooks (for medium frames)
\$1.50 ea

*Langstroth Nuc: Nucs, unlike deep and medium boxes, are not standardized. I've seen them come in the following 3 widths: 9", 9 1/4" and 9 5/8". If you order nucs, this dimension will need to be specified. 9 1/4" is ideal since it allows 3/8" crawl space between frames and less chance of rolling your ladies.

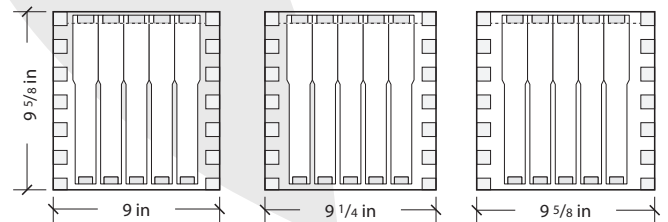



KITS



*Note: Foundation is wax with vertical wires with hooks. Brood body and honey supers ARE assembled.
Bottom board and covers are assembled.*

10 FRAME LANGSTROTH HIVE KIT:

- (1) Screened bottom board with reducer
- (1) Deep brood box with (10) frames and (10) wax foundations
- (2) Medium honey supers with (20) frames and (20) wax foundations
- (1) Inner cover
- (1) Telescoping lid.

\$328.50 *Frames ARE NOT assembled*

\$382.50 *Frames ARE assembled with wired wax foundation*



MIGRATION NUC:

These are bare bones. Solid Bottom board is screwed onto the nuc box. Disk opening. Lid can be screwed on also for easy transport. Nuc boxes are 9 1/4 wide. They do not come painted.





LONG LANGSTROTH

The Long Langstroth hive or Horizontal hive is exactly what it sounds like. This hive is made of 2x12 pine (redwood and cedar are also possibilities) and holds 34 frames. Designed to fit Langstroth deep frames and Langstroth 10-frame inner covers. Hive has an entrance on either end for holding two colonies.

The body of the hive is milled down to 1 3/8" to keep the notch profile for the frames and the inner covers as parallel as possible. Stand that supports the body is milled as well.

This Long Langstroth hive comes with (1) follower board with gap strip and (2) entrance reducers. Lid is hinged. Bottom of hive is screened with 1/8" hardware cloth and utilizes (3) independent IPM sliders. *Note: Hive does not come with inner covers - any standard 19 7/8" x 16 1/4" inner cover will do.*

The Long Langstroth Kit (LL34-Kit) comes with 34 frames (assembled with foundation) and (3) Inner covers with bee escapes. All you need are bees.

FRONT



BACK



LL34 - LONG LANGSTROTH
\$500.00

LL34-Kit - LONG LANGSTROTH KIT
\$729.90



Long Langstroth hive will not be painted. Lid (roof) may be polycarbonate or aluminum depending on material availability.



CUSTOM & NOT BEE RELATED

CUSTOM HIVES, JIGS & SPECIAL PROJECTS

Do you need a jig? Do you have a hive part that you cannot find? We love to reverse engineer things. If you have plans for a hive that you want built or have a bottom board style that you can't live without, give us a call. We love to tinker. Everything we make is designed first to minimize shop time and mishaps. There is nothing worse than trashing a nice piece of redwood.

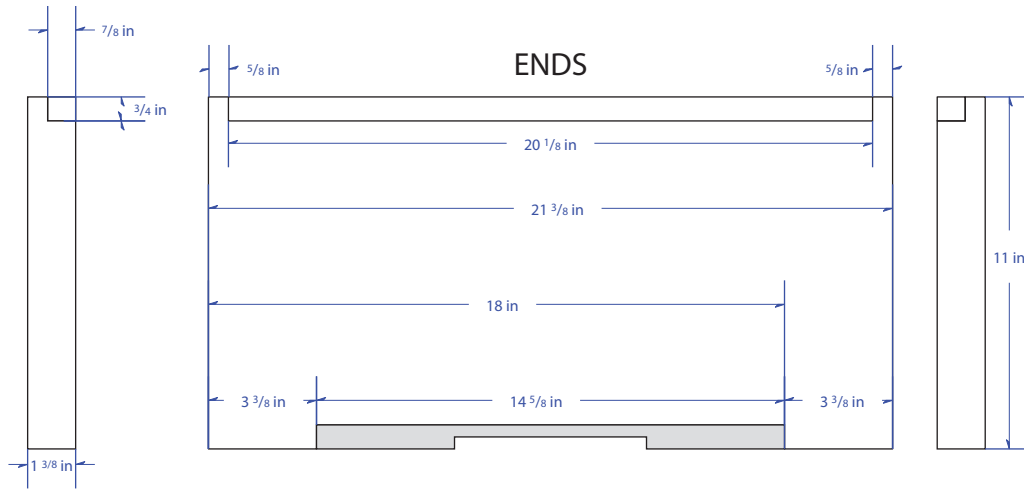

CUTTING BOARDS

Soft wood is great and all and we love making bee habitats... but we also love hardwood. We make end grain and face grain cutting boards. Every woodworker eventually makes a cutting board or two but we started and never stopped. Here is a peek. All we need is dimensions and we can make it for you.

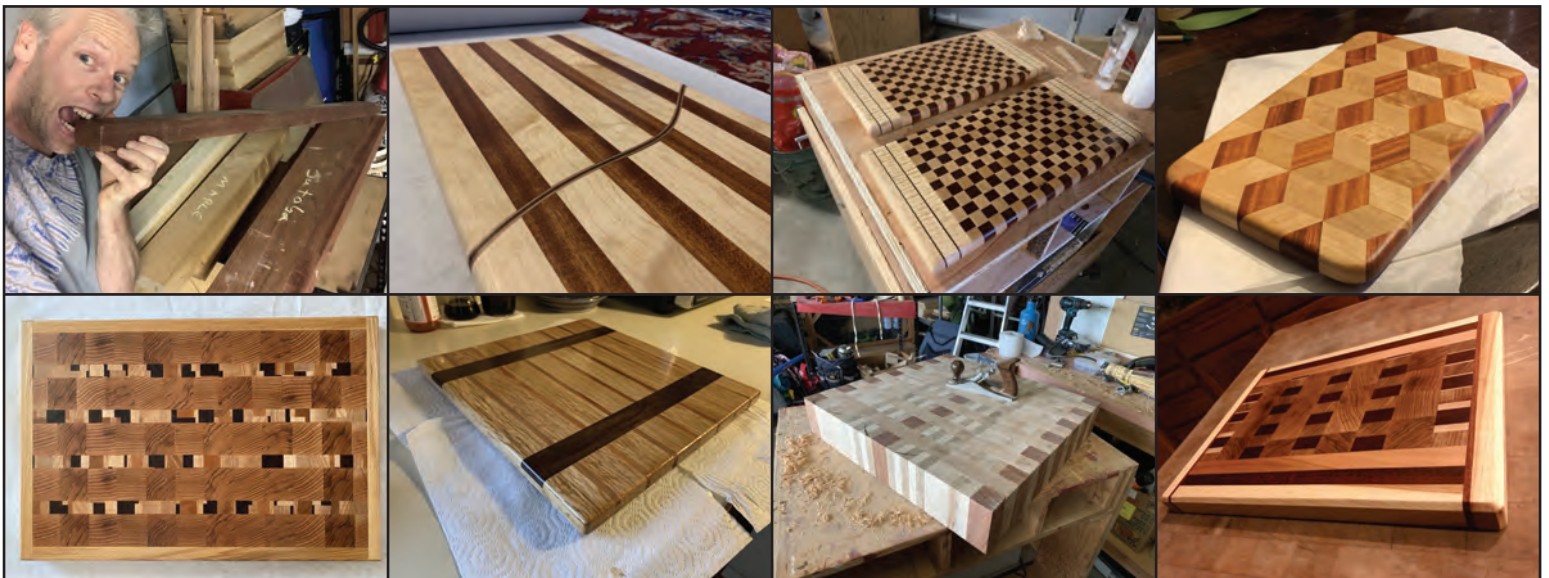



ORDER FORM

PART LIST

(tax is included)

Jan-23

PART #	DESCRIPTIONS	COST	QUANTITY	TOTAL	NUC WIDTH OPTIONS
BODIES (assembled)					
Deep					
10FD	10 Frame (19 7/8 x 16 1/4 x 9 5/8)	\$ 45.00	ea x <input type="text"/>	= \$ -	
8FD	8 Frame (19 7/8 x 14 x 9 5/8)	\$ 45.00	ea x <input type="text"/>	= \$ -	
Dnuc	Deep nuc (19 7/8 x ?? X 9 5/8)	\$ 35.00	ea x <input type="text"/>	= \$ -	Select Width
Medium					
10FM	10 Frame (19 7/8 x 16 1/4 x 6 5/8)	\$ 35.00	ea x <input type="text"/>	= \$ -	
8FM	8 Frame (19 7/8 x 14 x 6 5/8)	\$ 35.00	ea x <input type="text"/>	= \$ -	
Mnuc	Med Nuc (19 7/8 x ?? X 6 5/8)	\$ 25.00	ea x <input type="text"/>	= \$ -	Select Width
BOTTOM BOARDS (assembled)					
Screened Bottom Boards					
10FSBB	10 Frame	\$ 50.00	ea x <input type="text"/>	= \$ -	
8FSBB	8 Frame	\$ 50.00	ea x <input type="text"/>	= \$ -	
NSBB	nuc	\$ 30.00	ea x <input type="text"/>	= \$ -	Select Width
Solid Bottom Boards					
10FBB	10 Frame	\$ 40.00	ea x <input type="text"/>	= \$ -	
8FBB	8 Frame	\$ 40.00	ea x <input type="text"/>	= \$ -	
NBB	nuc	\$ 20.00	ea x <input type="text"/>	= \$ -	Select Width
INNER COVERS (assembled)					
10FIC	10 Frame w/ built in spacer	\$ 30.00	ea x <input type="text"/>	= \$ -	
8FIC	8 Frame w/ built in spacer	\$ 30.00	ea x <input type="text"/>	= \$ -	
NIC	nuc w/ built in spacer	\$ 25.00	ea x <input type="text"/>	= \$ -	Select Width
LIDS (assembled)					
Telescoping Lid					
10FTL	10 Frame	\$ 45.00	ea x <input type="text"/>	= \$ -	
8FTL	8 Frame	\$ 45.00	ea x <input type="text"/>	= \$ -	
NTL	nuc	\$ 30.00	ea x <input type="text"/>	= \$ -	
Migratory Lid					
10FML	10 Frame	\$ 20.00	ea x <input type="text"/>	= \$ -	
8FML	8 Frame	\$ 20.00	ea x <input type="text"/>	= \$ -	
NML	nuc	\$ 15.00	ea x <input type="text"/>	= \$ -	Select Width
FRAMES - wedge top & split bottom					
FR-922	Deep unassembled	\$ 2.50	ea x <input type="text"/>	= \$ -	
FR-932	Medium unassembled	\$ 2.50	ea x <input type="text"/>	= \$ -	
FR-932L	Deep frame assembled	\$ 3.50	ea x <input type="text"/>	= \$ -	
FR-932L	Medium Frame Assembled	\$ 3.50	ea x <input type="text"/>	= \$ -	
FOUNDATIONS - wired wax with hooks					
FN-261	Deep	\$ 2.00	ea x <input type="text"/>	= \$ -	
FN-237	Medium	\$ 1.50	ea x <input type="text"/>	= \$ -	
FN-261L	Deep Foundation Installed	\$ 3.00	ea x <input type="text"/>	= \$ -	
FN-237L	Medium Foundation Installed	\$ 2.50	ea x <input type="text"/>	= \$ -	
KITS - 1 Deep, 2 Medium, 1 inner cover, 1 telescoping lid with frames and foundations to match					
WJCHKUF	WJC Hive Kit (unassembled Frames)	\$ 328.50	ea x <input type="text"/>	= \$ -	
WJCHKAF	WJC Hive Kit (assembled Frames)	\$ 382.50	ea x <input type="text"/>	= \$ -	
Mnuc	Migration Nuc Kit (bare bones)	\$ 70.00	ea x <input type="text"/>	= \$ -	Select Width
Misc					
DFB	Deep Follower Board	\$ 10.00	ea x <input type="text"/>	= \$ -	
MFB	Medium Follower Board	\$ 8.00	ea x <input type="text"/>	= \$ -	
10FSS	10 Frame Spacer Shim	\$ 8.00	ea x <input type="text"/>	= \$ -	Entrance
ER	Entrance Reducer	\$ 3.00	ea x <input type="text"/>	= \$ -	
WW196	10 Frame Assembly Jig w/ springs	\$ 45.00	ea x <input type="text"/>	= \$ -	

Contact Information:

SUB TOTAL:	\$ -
Tax (7.25%)	\$ -

TOTAL:	\$ -
---------------	------

Notes: _____

Make checks payable to Wild Jasmine Creations. We also take digital and plastic.



We are a small family company so most orders are make-to-order style. That being said we will have plenty of frames and foundation available and always have a handful of products in stock.

Most of the products are self explanatory if you're already a beekeeper. Here is a break down of the Long Lang and WJC Kits:

34FLL - Long Langstroth (contact to order)

34 Frame horizontal hive with hinged lid and stand. Hive comes preassembled. Comes with (1) follower board and (2) entrance reducers.

34FLLK - Long Langstroth Kit (contact to order)

This product includes the 34FLL but also comes with:
 (34) FR-902 Deep Frames (assembled)
 (34) FN-216 Deep Foundations (installed)
 (3) 10FIC Inner Covers with (3) bee escapes

WJCHKUF - WJC Hive Kit (unassembled Frames)

This product is a kit and come with:
 (1) 10FSBB 10-Frame Screened Bottom Board w/reducer
 (1) 10FD Deep Body
 (2) 10FM Medium Super
 (1) 10FIC Inner Covers
 (10) FR-922 Deep Frames
 (10) FN-261 Deep Foundations
 (20) FR- 932 Medium Frames
 (20) FN-237 Medium Foundations

WJCHKAF - WJC Hive Kit (assembled Frames) is exactly the same except the all of the frames are assembled with foundations installed.

Labor

Frame assembly labor = \$1.00 per frame
 Foundation installation labor = \$1.00 per frame

Nuc width options

- 9"
- 9 1/4"
- 9 5/8"

